

Trails

The Story of Early Ancient Egypt

Find the objects below. . .

Which do you like best?

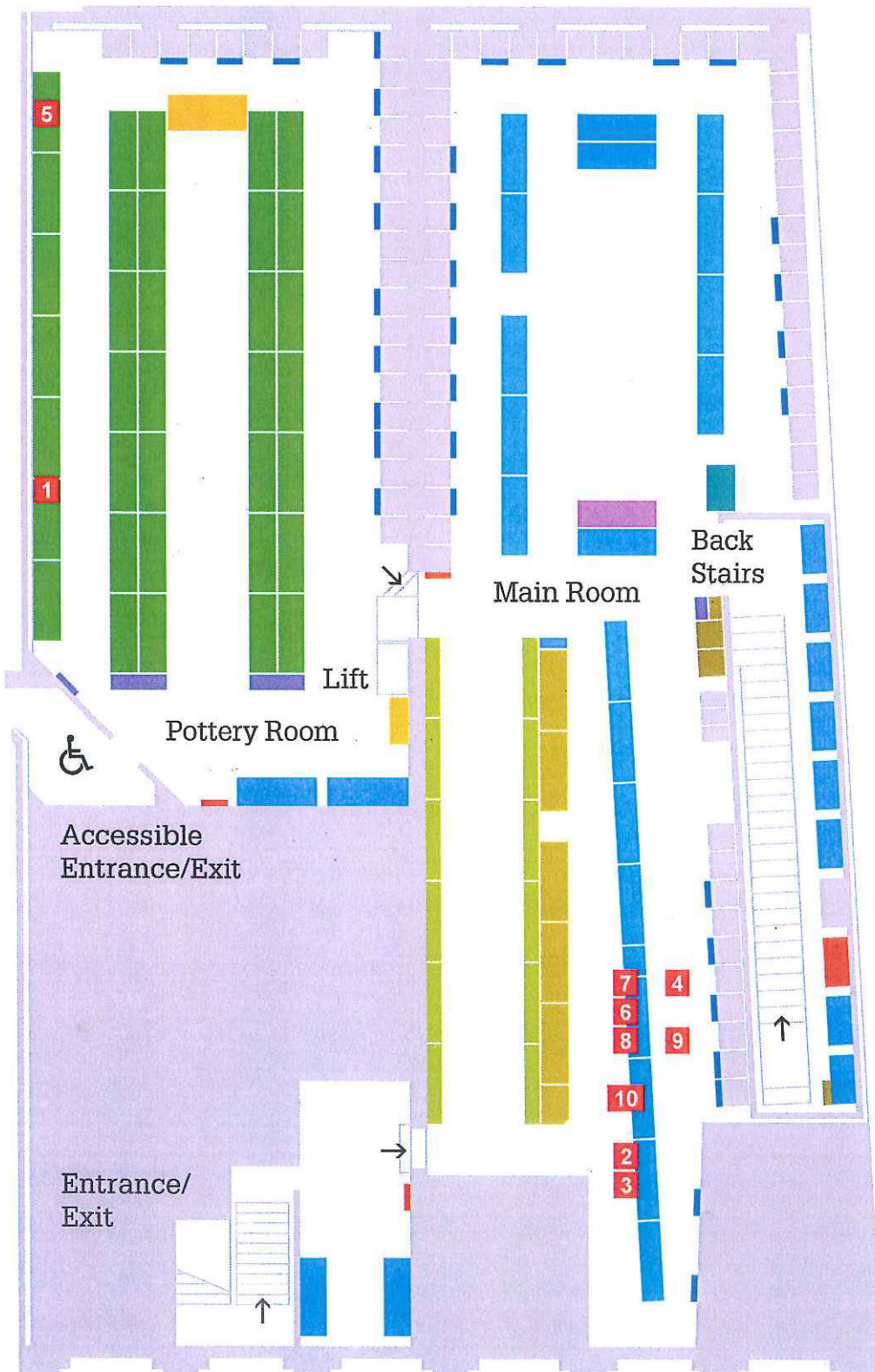

1 Black topped pottery
PC3 (UC9002)

2 Ivory bangle (2nd
shelf from top) B
(UC9148a)

3 Ivory vase (top shelf)
B (UC9054)

4 Faience beads worn
around the waist. BC1
(UC9250)

5 Vase showing a boat
PC8 (UC6333)

6 Stone Vessel (2nd
shelf) D (UC6313)

7 Fish shaped stone
vessel (2nd shelf from
top) D (UC10734)

8 Ivory spoon (2nd shelf
down) D (UC10737)

9 Flint knife (bottom
shelf) C (UC4130)

10 Afro comb (2nd shelf
down) C (UC4180)